



TWIN SKIN LENGTH ADAPTATION

Proper care and preparation is necessary to achieve optimum performance and extend the service life of Twin Skin skis. However, depending on snow conditions and the strength of the kick action, the skins will show signs of natural wear after they have been in use for some time. The skins should be replaced by a dealer if their kick action deteriorates considerably.

01. Cut out the template from the cardboard for the required skin length along the printed line.



02. Place the template which has been cut out on the rear of the skin at the end and attach it there with adhesive tape.

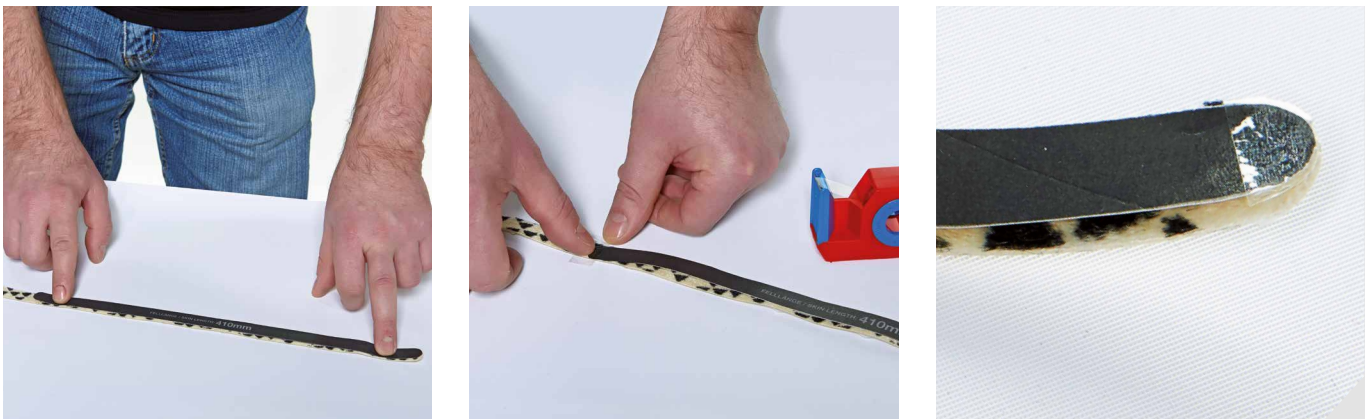

03. Shorten the skin along the cardboard template using a sharp pair of scissors.



Remove the cardboard and adhesive tape from the skin and stick the skin into place as described on the back side of the packaging.